

# EXPERIMENTAL ART FOUNDATION

Lion Arts Centre ◦ North Tce [West End] ◦ Adelaide ◦ South Australia ◦ +61-(0)8-82117505 ◦ info@eaf.asn.au ◦ www.eaf.asn.au ◦ Hours 11-5pm Tues-Fri. 2-5 Sat

## FLOORPLAN & ELEVATIONS

### MOVEABLE WALLS

- (2 x W4m x D60cm x H3.4)
- (1x 2m x 60cm x 3.4m)
- (2 x 3m x 60cm x 3.4m)

- fc. fire cupboards
- fl. floodlights
- sc. security camera
- e. exit light

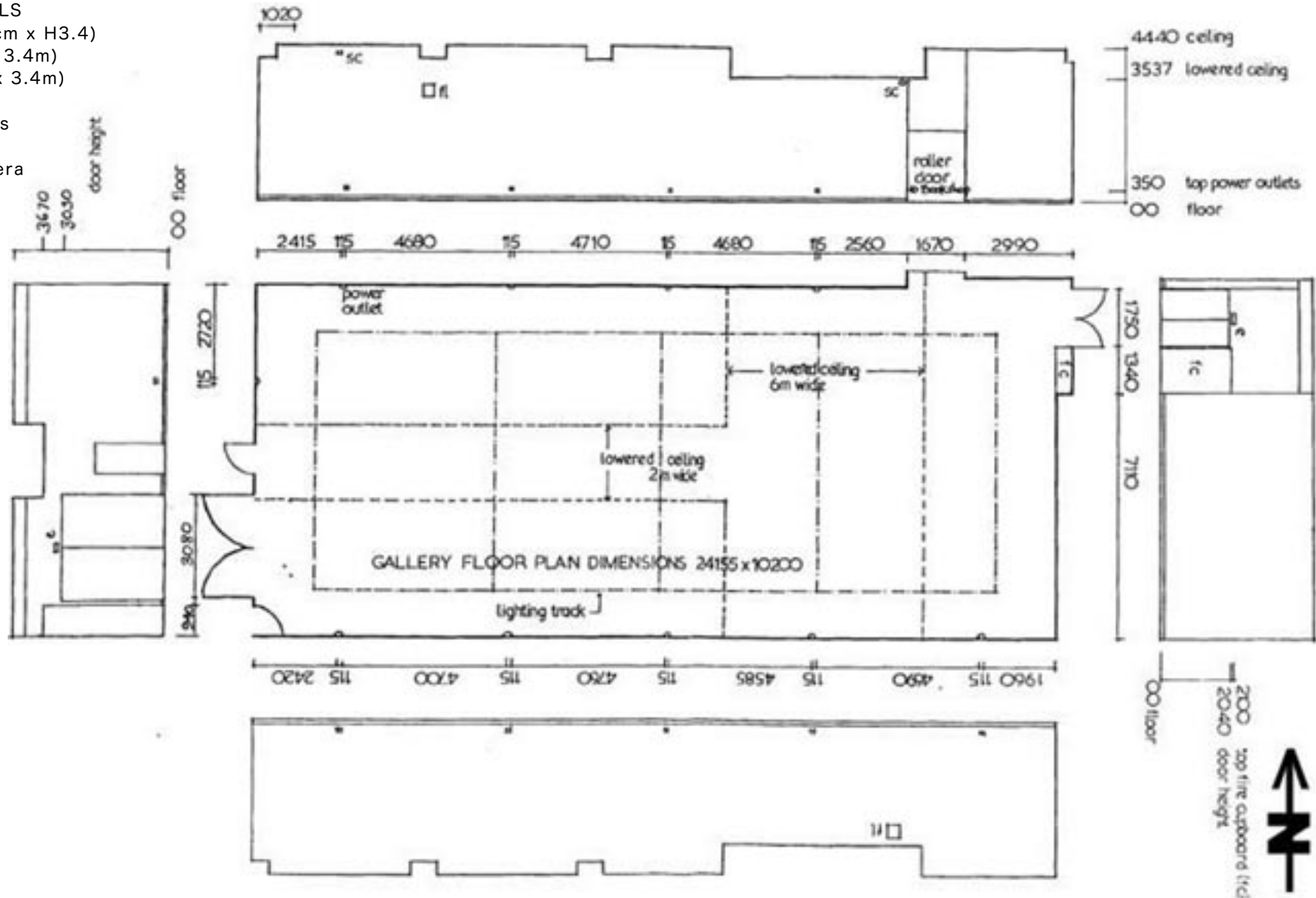

SCALE METRES 0 1 2 3 4 5